

Star-Ship Cabins



Owner's One-Bedroom Suite

CAT SA

Our Owner's One-Bedroom Suites boast their own separate bedroom which closes off from the rest of the suite. A dedicated lounge area and outdoor balcony, complete with open-air system, allow you to enjoy the views of your surroundings whatever the weather.

These suites also include a selection of special features including a spacious bathroom, walk-in wardrobe and Nespresso™ machine. Your complimentary mini-bar is restocked daily and, so you can keep up-to-date with the latest news, you'll have an iPad to use throughout your cruise. In order to offer you a more intimate dining experience, upon request, you can also order a continental breakfast, pre-dinner canapés and after-dinner sweet treats to enjoy in the privacy of your suite.

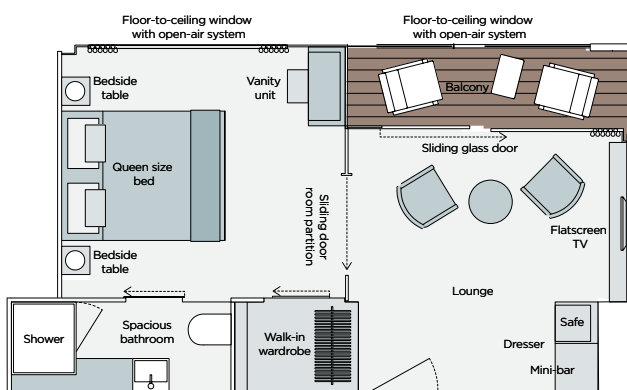

^On board Emerald Radiance, the layout of each Owner's One-Bedroom Suite differs, visit emeraldcrucises.com.au/star-ships

Your Owner's One-Bedroom Suite^

- Between 285ft² (26.5m²) and 315ft² (29.3m²)
- Outdoor private balcony with open-air system
- Separate bedroom and lounge area
- Queen-size or twin hotel-style beds
- Pillow menu
- En-suite bathroom with shower, indulgent toiletries, hair dryer, on board complimentary bathrobes and slippers
- Walk-in wardrobe
- Complimentary in-suite mini-bar, restocked daily with wine, beer and soft drinks
- Complimentary Nespresso™ machine
- Continental breakfast, pre-dinner canapés and after-dinner sweet treats served in your suite
- Four items of laundry per day
- An invite to the top table to enjoy dinner with the senior on board team
- Complimentary water, restocked daily
- Complimentary Wi-Fi
- Use of an iPad
- Flat screen TV and infotainment system
- Individual climate control
- Personal safe
- Umbrella
- Telephone
- Walking sticks



Emerald Riverview Suite

CAT RA

Guests sailing Portugal's Douro River on board Emerald Radiance will have the opportunity to book our Emerald Riverview Suite. Thoughtfully located at the back of the Star-Ship, floor-to-ceiling windows and our innovative indoor balcony system offer endless views of the magnificent locations that line the riverbanks, at any time of day.

At 300ft² (27.9m²), the size and layout of this wonderful suite is unique to the ship and features most of the fantastic inclusions you'd expect from the Owner's One-Bedroom Suite. Enjoy hotel-style beds, a pillow menu, a Nespresso™ machine and a complimentary in-suite mini-bar.

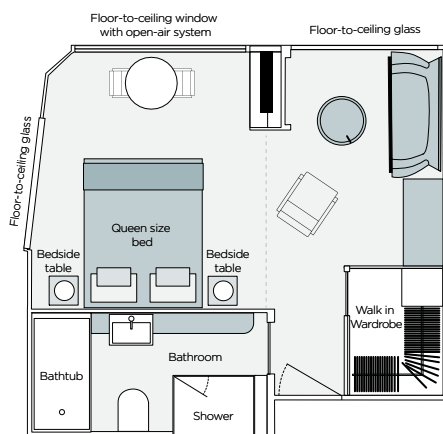

Important Information: The cabin and deck plans, sizes and photographs are an indication only and are subject to variation.

Your Riverview Suite

- 300ft² (27.9m²)
- Private balcony with open-air system
- Separate bedroom and lounge area
- Queen-size or twin hotel-style beds
- Pillow menu
- En-suite bathroom with shower, indulgent toiletries, hair dryer, on board complimentary bathrobes and slippers
- Walk-in wardrobe
- Complimentary in-suite mini-bar, restocked daily with wine, beer and soft drinks
- Complimentary Nespresso™ machine
- Continental breakfast, pre-dinner canapés and after-dinner sweet treats served in your suite
- Four items of laundry per day
- An invite to the top table to enjoy dinner with the senior on board team
- Complimentary water, restocked daily
- Complimentary Wi-Fi
- Use of an iPad
- Flat screen TV and infotainment system
- Individual climate control
- Personal safe
- Umbrella
- Telephone
- Walking sticks



Emerald Grand Balcony Suite

CAT 5

Each of our Emerald Grand Balcony Suites features a number of fantastic inclusions, such as an in-suite Nespresso™ machine for that added home comfort, so that you can relax with a hot beverage at any time, day or night. You'll also have the option to order a delicious continental breakfast to enjoy on the balcony. And, for the perfect start and finish to your evening meal, you can enjoy pre-dinner canapés and after-dinner sweet treats courtesy of your exclusive room service, which is included in the price of your suite.

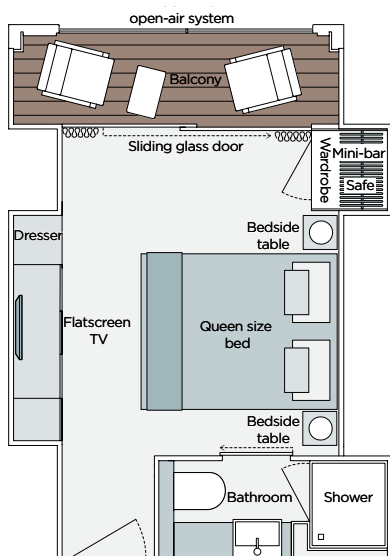

Please note: Cabin 316 on the Rhine, Main, Danube and Moselle and cabin 308 on the Rhône and Saône have a slightly varied cabin layout.

Your Grand Balcony Suite

- Between 207ft² (19.3m²) and 210ft² (19.5m²)
- Outdoor private balcony with open-air system
- Queen-size or twin hotel-style beds
- Pillow menu
- En-suite bathroom with shower, indulgent toiletries, hair dryer, on board complimentary bathrobes and slippers
- Mini-bar
- Complimentary Nespresso™ machine
- Continental breakfast, pre-dinner canapés and after-dinner sweet treats served in your suite
- Two items of laundry per day
- Complimentary water, restocked daily
- Complimentary Wi-Fi
- Flat screen TV and infotainment system
- Individual climate control
- Personal safe
- Umbrella
- Telephone
- Walking sticks



Emerald Panorama Balcony Suite

CAT P

CAT A

CAT R

CAT B

CAT C

These spectacular suites showcase our revolutionary indoor balcony design. With the touch of a button, the upper part of the suite's floor-to-ceiling window drops down to unveil uninterrupted views of the stunning scenery.

You'll also find a mini-fridge, complimentary Wi-Fi, a flat-screen TV and infotainment system, a safe for your valuables and plenty of storage.

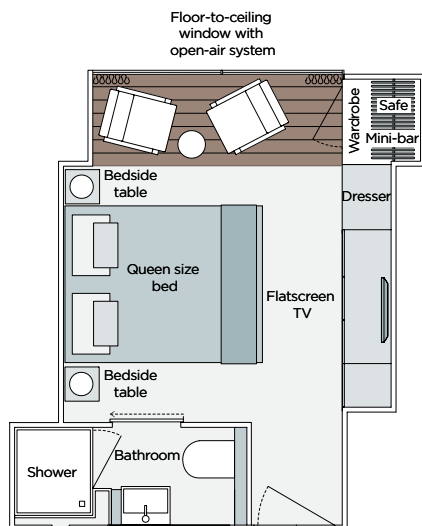

Important Information: The cabin and deck plans, sizes and photographs are an indication only and are subject to variation.

Your Emerald Panorama Balcony Suite

- Between 160ft² (14.9m²) and 180ft² (16.7m²)
- Indoor balcony with open-air system
- Queen-size or twin hotel-style beds
- En-suite bathroom with shower, indulgent toiletries, hair dryer, on board complimentary bathrobes and slippers
- Mini-bar
- Complimentary water, restocked daily
- Complimentary Wi-Fi
- Flat screen TV and infotainment system
- Individual climate control
- Personal safe
- Umbrella
- Telephone
- Walking sticks



Emerald Stateroom

CAT D

CAT E

CAT F

Marrying excellent comfort with refined and practical design, an Emerald Stateroom provides excellent value for money.

Emerald Single Stateroom

CAT ES

Our Star-Ships on the Danube, Moselle, Rhine & Rhone offer two Emerald Single Staterooms featuring a picture window and a wealth of quality facilities.

Your Emerald Stateroom

- Between 153ft² (14.3m²) and 170ft² (15.8m²)
- Picture window
- Queen-size or twin hotel-style beds
- En-suite bathroom with shower, indulgent toiletries, hair dryer, on board complimentary bathrobes and slippers
- Mini-bar
- Complimentary water, restocked daily
- Complimentary Wi-Fi
- Flat screen TV and infotainment system
- Individual climate control
- Personal safe
- Umbrella
- Telephone
- Walking sticks

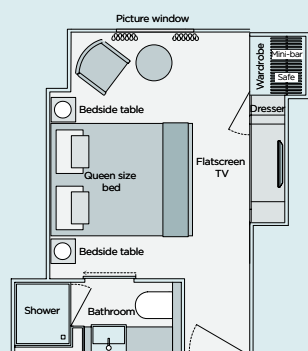

Your Emerald Single Stateroom

- Between 105ft² (9.8m²) and 117ft² (10.9m²)
- Picture window
- Deluxe single bed
- En-suite bathroom with shower, indulgent toiletries, hair dryer, on board complimentary bathrobes and slippers
- Mini-bar
- Complimentary water, restocked daily
- Complimentary Wi-Fi
- Flat screen TV and infotainment system
- Individual climate control
- Personal safe
- Umbrella
- Telephone
- Walking sticks

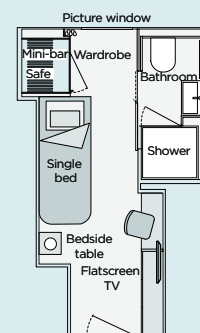

Danube, Rhine, Main & Moselle deck plans

Emerald Sky & Emerald Star

• Built: 2014 • Length: 443ft (135m) • Guests: 180 • Cabins: 91 • Crew Members: 51

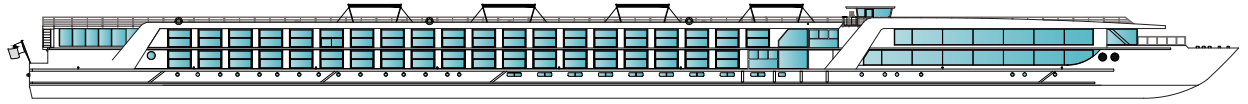

Sun Deck

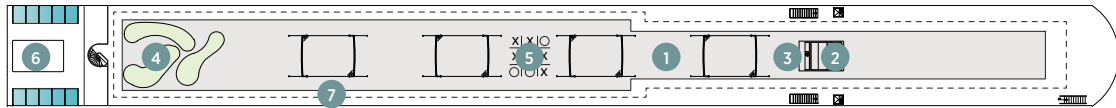

Horizon Deck

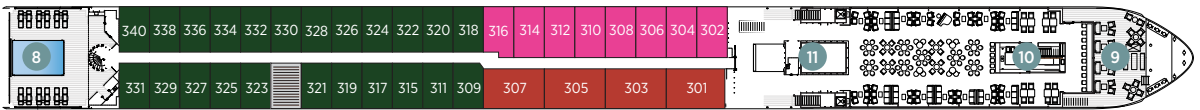

Vista Deck



Riviera Deck

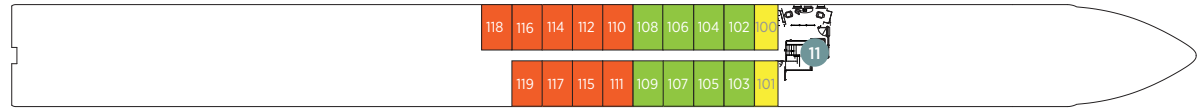

Cabin Categories		
Horizon Deck		
	Size ft ² (m ²)	
CAT SA	Owner's One-Bedroom Suite	315ft ² (29.3m ²)
CAT S	Grand Balcony Suite*	210ft ² (19.5m ²)
CAT A	Emerald Panorama Balcony Suite	180ft ² (16.7m ²)
Vista Deck		
	Size ft ² (m ²)	
CAT B	Emerald Panorama Balcony Suite	180ft ² (16.7m ²)
CAT C	Emerald Panorama Balcony Suite	180ft ² (16.7m ²)
Riviera Deck		
	Size ft ² (m ²)	
CAT D	Emerald Stateroom	162ft ² (15m ²)
CAT E	Emerald Stateroom	162ft ² (15m ²)
CAT ES	Emerald Single Stateroom	117ft ² (10.9m ²)

- 1 Sun Deck with Deck Chairs[^]
- 2 Navigation Bridge
- 3 Sky Barbecue
- 4 Golf Putting Green
- 5 Games Area
- 6 Retractable Glass Roof
- 7 Walking Track
- 8 Daytime Pool & Bar/Evening Cinema
- 9 The Terrace
- 10 Horizon Bar & Lounge
- 11 Lift
- 12 Reception
- 13 Wellness Area
- 14 Fitness Area
- 15 Reflections Restaurant

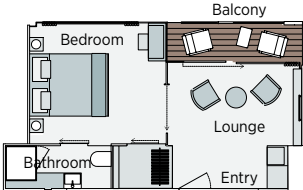

Owner's One-Bedroom Suite
315ft² (29.3m²)
CAT SA

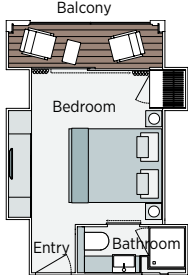

Grand Balcony Suite
210ft² (19.5m²)
CAT S

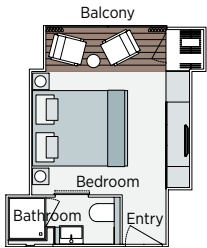

Emerald Panorama Balcony Suite
180ft² (16.7m²)
CAT A CAT B CAT C

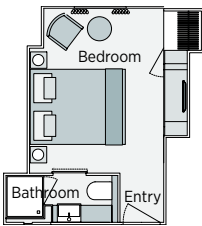

Emerald Stateroom
162ft² (15m²)
CAT D CAT E

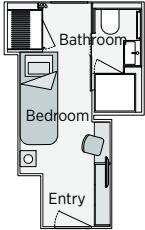

Emerald Single Stateroom
117ft² (10.9m²)
CAT ES

Important Information: On Emerald Sky and Emerald Star, cabin 202 has modified entry, bathroom configuration with personal assistance fittings and has no decked area with table and chairs. The cabin and deck plans, sizes and photographs are an indication only and are subject to variation.

[^] Due to safety, the Sun Deck will be closed when travelling under low bridges.

* Cabin 316 has a slightly varied layout.

Danube, Rhine, Main & Moselle deck plans

Emerald Dawn, Emerald Sun & Emerald Luna

• Built: 2015 & 2020 • Length: 443ft (135m) • Guests: 180 • Cabins: 91 • Crew Members: 51

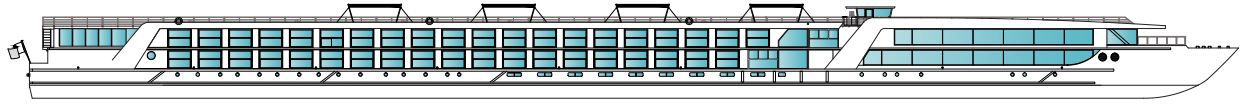

Sun Deck

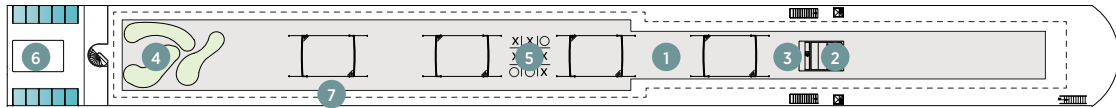

Horizon Deck

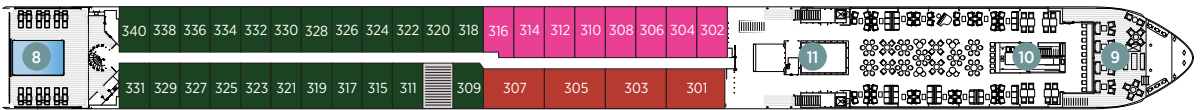

Vista Deck



Riviera Deck

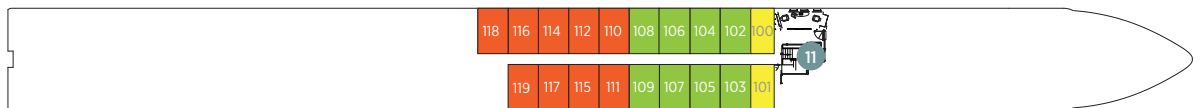

Cabin Categories		
Horizon Deck		
	Size ft ² (m ²)	
CAT SA	Owner's One-Bedroom Suite	315ft ² (29.3m ²)
CAT S	Grand Balcony Suite*	210ft ² (19.5m ²)
CAT A	Emerald Panorama Balcony Suite	180ft ² (16.7m ²)
Vista Deck		
	Size ft ² (m ²)	
CAT B	Emerald Panorama Balcony Suite	180ft ² (16.7m ²)
CAT C	Emerald Panorama Balcony Suite	180ft ² (16.7m ²)
Riviera Deck		
	Size ft ² (m ²)	
CAT D	Emerald Stateroom	162ft ² (15m ²)
CAT E	Emerald Stateroom	162ft ² (15m ²)
CAT ES	Emerald Single Stateroom	117ft ² (10.9m ²)

- 1 Sun Deck with Deck Chairs[^]
- 2 Navigation Bridge
- 3 Sky Barbecue
- 4 Golf Putting Green
- 5 Games Area
- 6 Retractable Glass Roof
- 7 Walking Track
- 8 Daytime Pool & Bar/Evening Cinema
- 9 The Terrace
- 10 Horizon Bar & Lounge
- 11 Lift
- 12 Reception
- 13 Wellness Area
- 14 Fitness Area
- 15 Reflections Restaurant

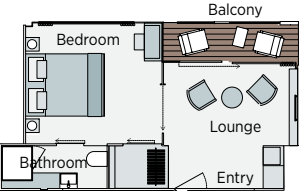

Owner's One-Bedroom Suite
315ft² (29.3m²)
CAT SA

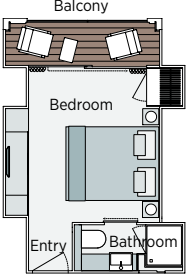

Grand Balcony Suite
210ft² (19.5m²)
CAT S

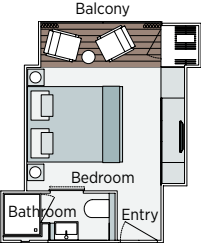

Emerald Panorama Balcony Suite
180ft² (16.7m²)
CAT A CAT B CAT C

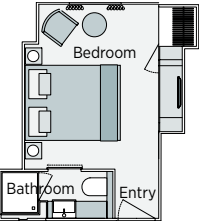

Emerald Stateroom
162ft² (15m²)
CAT D CAT E

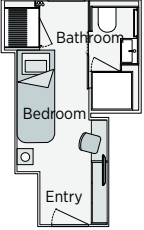

Emerald Single Stateroom
117ft² (10.9m²)
CAT ES

Important Information: The cabin and deck plans, sizes and photographs are an indication only and are subject to variation.

[^] Due to safety, the Sun Deck will be closed when travelling under low bridges.

* Cabin 316 has a slightly varied layout.

Danube, Rhine, Main & Moselle deck plans

Emerald Destiny

• Built: 2017 • Length: 443ft (135m) • Guests: 180 • Cabins: 91 • Crew Members: 51

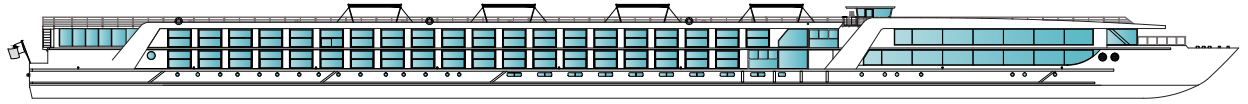

Sun Deck

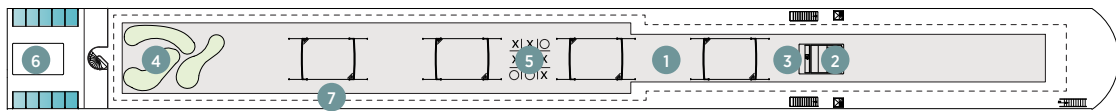

Horizon Deck

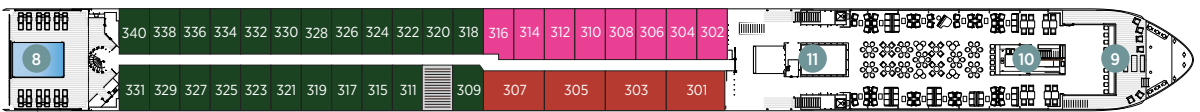

Vista Deck



Riviera Deck

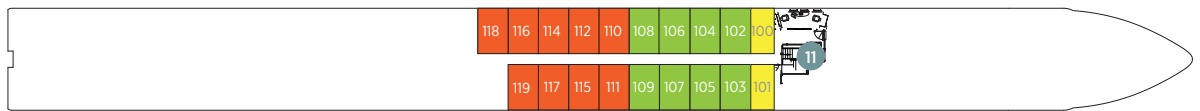

Cabin Categories		
Horizon Deck		
	Size ft ² (m ²)	
CAT SA	Owner's One-Bedroom Suite	315ft ² (29.3m ²)
CAT S	Grand Balcony Suite*	210ft ² (19.5m ²)
CAT A	Emerald Panorama Balcony Suite	180ft ² (16.7m ²)
Vista Deck		
	Size ft ² (m ²)	
CAT B	Emerald Panorama Balcony Suite	180ft ² (16.7m ²)
CAT C	Emerald Panorama Balcony Suite	180ft ² (16.7m ²)
Riviera Deck		
	Size ft ² (m ²)	
CAT D	Emerald Stateroom	162ft ² (15m ²)
CAT E	Emerald Stateroom	162ft ² (15m ²)
CAT ES	Emerald Single Stateroom	117ft ² (10.9m ²)

- 1 Sun Deck with Deck Chairs[^]
- 2 Navigation Bridge
- 3 Sky Barbecue
- 4 Golf Putting Green
- 5 Games Area
- 6 Retractable Glass Roof
- 7 Walking Track
- 8 Daytime Pool & Bar/Evening Cinema
- 9 The Terrace
- 10 Horizon Bar & Lounge
- 11 Lift
- 12 Reception
- 13 Wellness Area
- 14 Fitness Area
- 15 Reflections Restaurant

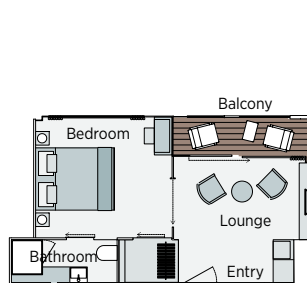

Owner's One-Bedroom Suite
315ft² (29.3m²)
CAT SA

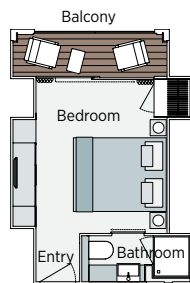

Grand Balcony Suite
210ft² (19.5m²)
CAT S

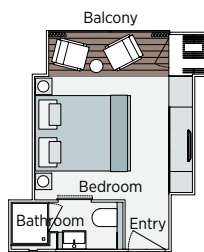

Emerald Panorama Balcony Suite
180ft² (16.7m²)
CAT A CAT B CAT C

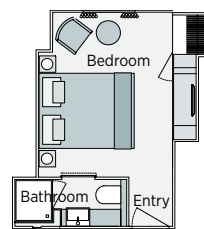

Emerald Stateroom
162ft² (15m²)
CAT D CAT E

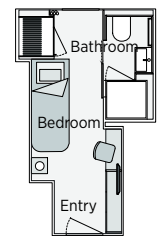

Emerald Single Stateroom
117ft² (10.9m²)
CAT ES

Important Information: The cabin and deck plans, sizes and photographs are an indication only and are subject to variation.

[^] Due to safety, the Sun Deck will be closed when travelling under low bridges.

* Cabin 316 has a slightly varied layout.